

Technical Requirement:

- This product should meet EU RoHs related requirement.
- The surface of plastic part should be without any crackle such as burr, lack and so on phenomenon.
- The surface of metal part should be without any defect such as scour, nick, oxidation and plating problem.
- The electronic performance should be the same as spec.

Dimensions of PC board holes(Commend)

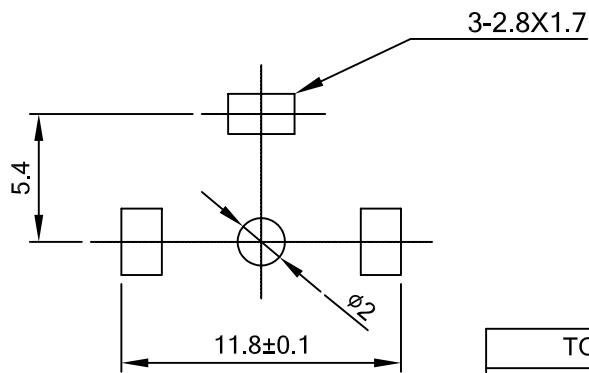

4	Base	1	H62 t=0.4	CuSn
3	Insulator	1	Fiberglass	—
2	Radio-Frequency Needle	1	H62 t=0.3	CuSn
1	Outer Conductor	1	H65 t=0.4	CuSn
No.	Name	QTY	Material	Plating

TOLERANCE	
LINEAR	ANGLES
X. ±	X° ±
X < 6 ± 0.2	.X° ±
6 ≤ X < 20 ± 0.3	.XX° ±
X ≥ 20 ± 0.4	.XXX° ±



TITLE:		IEC Connector With Bracket			
PART NO.		GTi07-30129			
DWG NO.		GTi07-30129			
UNITS	SCALE	SHEET	REV		
MM	NONE	1 OF 4	A		

[A]	ISSUED	FOX	12/20/07
REV	ECN NO.	NAME	DATE

NOTES:

1. SCOPE:

THIS SPECIFICATION IS SUITABLE FOR IF TYPE RADIO-FREQUENCY SERIES, WHICH IS SUITABLE FOR INPUT/OUTPUT OF AUDIO/VIDEO SIGNAL, USED AS CONNECTION PART

2. CONSTRUCTION: THE EXTERNAL DIMENSIONS OF THIS PRODUCT AND ITS INTERNAL TOLERANCES ARE BASED ON RELEVANT DRAWINGS.

3. MATERIAL: REFER TO THE MATERIAL CHART SHOWN ON THE DRAWING.

4. APPLIED ENVIRONMENT:

a. TEMPERATURE: -40°C ~ 70°C.

b. RELATIVE HUMIDITY: 90% ~ 95% (55°C ± 2°C).

5. ELECTRICAL PROPERTIES:

NO	ITEMS	TECHNICAL CONDITIONS	TECHNICAL REQUIREMENTS	MEMO
5.1	RATING LOAD	DC 12V	1A	
5.2	DIELECTRIC STRENGTH	AC 500V(50 Hz ~60Hz) 1 MIN 2mA	NO ABNORMALITY, NO BREAKDOWN NO OVER ARC	
5.3	CONTACT RESISTANCE	FREQUENCY: 1000Hz; CURRENT <100mA VOLTAGE: 20mV	≤30mΩ	
5.4	INSULATION RESISTANCE	APPLYING DC 500V BETWEEN PIN AND OUT CONDUCTOR AND TEST IT AFTER 1 MIN.	≥100MΩ	

6. MECHANICAL PROPERTIES

NO	ITEMS	TECHNICAL CONDITIONS	TECHNICAL REQUIREMENTS	MEMO
6.1	INSERTION FORCE	USE STANDARD PLUG. MEASURE IT AFTER 3 TIMES OF INSERTION	15N ~ 55N	
	EXTRACTION FORCE	USE STANDARD PLUG. MEASURE IT AFTER 3 TIMES OF EXTRACTION	10N ~ 50N	
6.2	TERMINAL STRENGTH	PULL THE TERMINAL WITH 20N FORCE IN AXES DIRECTION FOR 1 MINUTE, THE JACK WILL NOT BE BROKEN OR DAMAGED.	APPERANCE: NO DEFORMING AND LOOSING	
			CONTACT RESISTANCE: ≤30mΩ	
			INSULATION RESISTANCE: ≥100mΩ	
			VOLTAGE WITHSTANDING AC500V, 2mA, 1 MIN, NO BREAKDOWN NO OVER ARC	

A

A

NO	ITEMS	TECHNICAL CONDITIONS	TECHNICAL REQUIREMENTS	MEMO
6.3	MECHANICAL LIFE	INSERTING AND EXTRACTING 1000 TIMES WITHOUT LOAD AT THE SPEED OF 10 CYCLES ~ 20 CYCLES PER MINUTE.	APPEARANCE: NO DEFORMING AND LOSING	
			CONTACT RESISTANCE: <50mΩ	
			INSULATION RESISTANCE: ≥100mΩ	
			VOLTAGE WITHSTANDING AC500V, 2mA, 1 MIN, NO BREAKDOWN NO OVER ARC	
			INSERTION FORCE: 15 N ~ 55N	
			EXTRACTION FORCE: 10 N ~ 50N	

B

B

7. SOLDERING PROPERTIES

NO	ITEMS	TECHNICAL CONDITIONS	TECHNICAL REQUIREMENTS	MEMO
7.1	SOLDER-ABILITY	SOLDER BATH METHOD: TEMPERATURE: 230°C ± 5°C FLUX DIPPING TIME 3 SECONDS TIME: 3s ± 0.5s	SOLDER COVERED SURFACE >90%	

C

C

NO	ITEMS	TECHNICAL CONDITIONS	TECHNICAL REQUIREMENTS	MEMO
7.2	SOLDERING WITHSTANDING	SOLDER BATH METHOD TEMPERATURE: 260°C ± 5 °C FLUX DIPPING TIMES 3 SECONDS TIME: 3s ± 1s	APPEARANCE: TERMINAL NO LOOSING	
			CONTACT RESISTANCE: <50mΩ	
			INSULATION RESISTANCE: ≥100MΩ	
			VOLTAGE WITHSTANDING: AC500V 2mA, 1MIN, NO BREAKDOWN, NO OVER ARC.	
			INSERTION FORCE: 15 N ~ 55N	
			EXTRACTION FORCE: 10 N ~ 50N	

D

D

8. DURABILITY

NO	ITEMS	TECHNICAL CONDITIONS	TECHNICAL REQUIREMENTS	MEMO
8.1	HEAT WITHSTANDING	TEMPERATURE: 70°C± 2°C, KEEP 96 HOURS AND MEASURE AFTER ONE HOUR RECOVERY IN STANDARD ATMOSPHERIC CONDITIONS	APPEARANCE: TERMINAL NO LOOSING	
			CONTACT RESISTANCE: <50mΩ	
			INSULATION RESISTANCE: ≥100MΩ	
			VOLTAGE WITHSTANDING: AC500V 2mA, 1MIN, NO BREAKDOWN, NO OVER ARC.	
			INSERTION FORCE: 15 N ~ 55N	
			EXTRACTION FORCE: 10 N ~ 50N	

E

E



PART NO.	GTI07-30129	SHEET	REVISION
DWG NO.	GTI07-30129	3 OF 4	SEE SHEET 1

NO	ITEMS	TECHNICAL CONDITIONS	TECHNICAL REQUIREMENTS	MEMO
8.2	HUMIDITY WITHSTANDING	TEMPERATURE: 40°C ± 2°C RELATIVE HUMIDITY 90% ~ 95% TIME 96 HOURS MEASURE AFTER ONE HOUR RECOVERY IN STANDARD ATSMOSPHERIC CONDITIONS	APPERANCE: DEFORMING NO LOOSING	
			CONTACT RESISTANCE: ≤ 50mΩ	
			INSULATION RESISTANCE: ≥ 100MΩ	
			VOLTAGE WITHSTANDING: DC500V 2 mA, 1MIN, NO BREAKDOWN, NO OVER ARC.	
			INSERTION FORCE: 15 N ~ 55N	
			EXTRACTION FORCE: 10 N ~ 50N	

NO	ITEMS	TECHNICAL CONDITIONS	TECHNICAL REQUIREMENTS	MEMO
8.3	COLD WITHSTANDING	TEMPERATURE: 40°C ± 3°C RELATIVE HUMIDITY 90% ~ 95% TIME 96 HOURS MEASURE AFTER ONE HOUR RECOVERY IN STANDARD ATSMOSPHERIC CONDITIONS	APPERANCE: DEFORMING NO LOOSING	
			CONTACT RESISTANCE: < 50mΩ	
			INSULATION RESISTANCE: ≥ 100MΩ	
			VOLTAGE WITHSTANDING: DC500V 2 mA, 1MIN, NO BREAKDOWN, NO OVER ARC.	
			INSERTION FORCE: 15 N ~ 55N	
			EXTRACTION FORCE: 10 N ~ 50N	

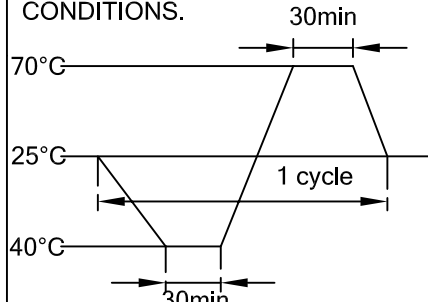
NO	ITEMS	TECHNICAL CONDITIONS	TECHNICAL REQUIREMENTS	MEMO	
8.4	TEMPERATURE CYCLE	DECREASE FROM 25°C TO -40°C IN 30 MINUTES, THEN INCREASE FROM -40° C TO 70°C TO COMPLETE ONE CYCLE. TOTAL 5 CYCLES, MEASURE AFTER 24 HOURS OF RECOVERY IN STANDARD ATMOSPHERIC CONDITIONS. 	APPERANCE :NO DEFORMING AND LOOSING	APPERANCE HIGH-LOW TEMPERATURE TESTING CHAMBER	
			CONTACT RESISTANCE: < 50mΩ		
			INSULATION RESISTANCE: ≥ 100MΩ		
			VOLTAGE WITHSTANDING: DC500V 2 mA, 1MIN, NO BREAKDOWN, NO OVER ARC.		
			INSERTION FORCE: 15 N ~ 55N		
			EXTRACTION FORCE: 10 N ~ 50N		

9. THIS PRODUCT SHOULD MEET EU RoHs RELATED REQUIREMENT.



PART NO.	GTi07-30129	SHEET	REVISION
DWG NO.	GTi07-30129	4 OF 4	SEE SHEET 1