

D
 DATE CODE:BLACK
 YY:YEAR
 MM:MONTH(01~12)
 DD:DAY(01~31)

A 0.15
 COPLANARITY

2-1.20^{+0.00}_{-0.10}

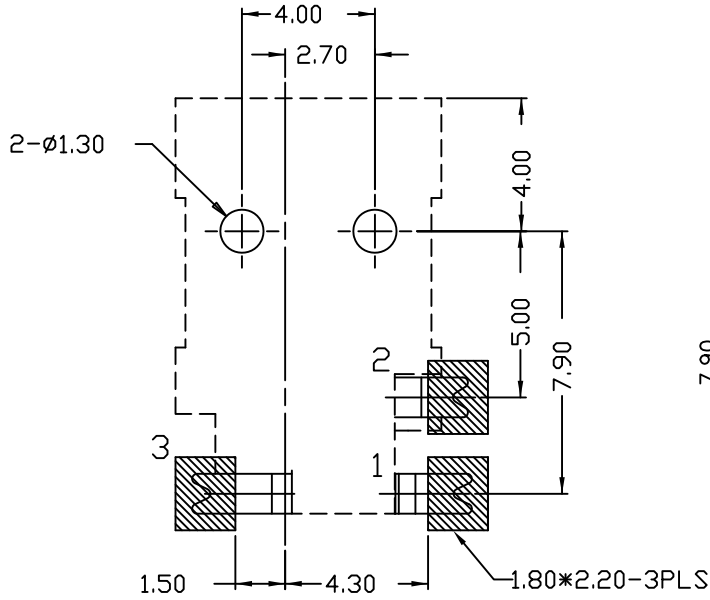

<TOP VIEW>

Recommended Pads Layout

NOTE: TOLERANCE FOR PCB LAYOUT IS ± 0.05

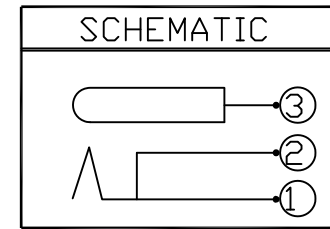
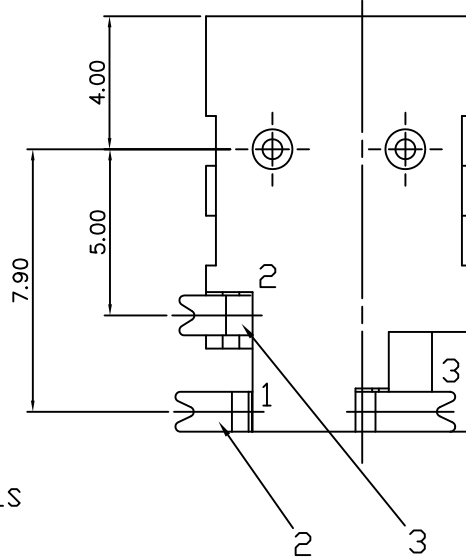

ITEM	NAME	MATERIAL	FINISH	Q'TY	NOTE
4	PIN	BRASS	SILVER	1	
3	CONTACT	BRASS	SILVER	1	
2	CONTACT	TiCu	SILVER	1	
1	PLASTIC HOUSING	PA9T	BLACK	1	UL94V-0

REV	ECN NO.	NAME	DATE	TOLERANCE	
				LINEAR	ANGLES
D	CHANGED THE COLOR OF DATE CODE ADDED THE COLOR OF HOUSING	Hanson	7/28/10	X.±	X'.± 5'
C	CHANGED TOLERANCES	FOX	10/27/08	.X±0.20	.XX'±
B	ADDED NOTES	FOX	10/08/08	.X±0.30	.X'± 3'
A	ISSUED	AXL	11/22/05	.XX±0.20	.XX'±
REV	ECN NO.	NAME	DATE	.XXX±	.XXX'±



TITLE:		ø1.65mm DC POWER JACK			
PART NO.		SDC209			
DWG NO.		SC-10194			
UNITS	SCALE	SHEET	REV		
				MM	NONE

APPD:	MAT'L:
CHKD:	FINISH:
DRWN: FOX	Q'TY:

B NOTES:

1. GENERAL

THIS SPECIFICATION COVERS THE GENERAL REQUIREMENTS OF THE DC POWER JACK, CLASS 3 OF TYPE A, APPLIED ON AUDIO SYSTEMS AND OTHER RELATED ELECTRONIC APPARATUS. ESPECIALLY THIS SPECIFICATION APPLIED ON THE HIGH TEMPERATURE PLASTIC FOR THE REFLOW SOLDERING PROCESS.

MATED PLUG

THE MATED PLUG SHOULD COMPLIED WITH STANDARD PLUG AS SHOWN IN THE DRAWING ATTACHED.

2. MECHANICAL

2a. TERMINAL STRENGTH

THE TERMINALS SHALL BE CAPABLE OF WITHSTANDING A FORCE OF 500 GRAMS APPLIED IN ANY DIRECTION FOR 10 SECONDS WITHOUT LOSING OR BREAKDOWN, EXCEPT BENDING THE TERMINALS.

2b. INSERTION AND EXTRACTION FORCE

INSERTION FORCE

CONDITIONS	VALUE OF SPEC.
INITIAL CONDITION	0.3 Kgs TO 2.0 Kgs
AFTER LIFE TEST AFTER HUMIDITY TEST AFTER HEAT TEST AFTER COLD TEST AFTER RESISTANCE TO SOLDERING HEAT TEST	0.2 Kgs TO 2.0 Kgs

EXTRACTION FORCE

CONDITIONS	VALUE OF SPEC.
INITIAL CONDITION	0.3 Kgs TO 2.0 Kgs
AFTER LIFE TEST AFTER HUMIDITY TEST AFTER HEAT TEST AFTER COLD TEST AFTER RESISTANCE TO SOLDERING HEAT TEST	0.2 Kgs TO 2.0 Kgs

3. ELECTRICAL

3a. WITHSTAND VOLTAGE TEST

250 VOLTS AC/RMS OF COMMERCIAL FREQUENCY 50 TO 60 Hz APPLIED BETWEEN ADJACENT OPEN TERMINALS FOR 1 MINUTE WITHOUT BREAKDOWN.

3b. INSULATION RESISTANCE.

THE INSULATION RESISTANCE BETWEEN MUTUAL INSULATED CONTACTS SHOULD COMPLIED WITH FOLLOWING SPECIFICATION UNDER 250 VOLTS DC (METHOD C UNLESS OTHERWISE SPECIFIED).

3c. RATED VOLTAGE 12VOLTS DC

3d. RATED CURRENT 3.0 AMPERES DC

PART NO.	SDC209	SHEET	REVISION
DWG NO.	SC-10194	2 OF 2	SEE SHEET 1