

21PIN SCART PLUG

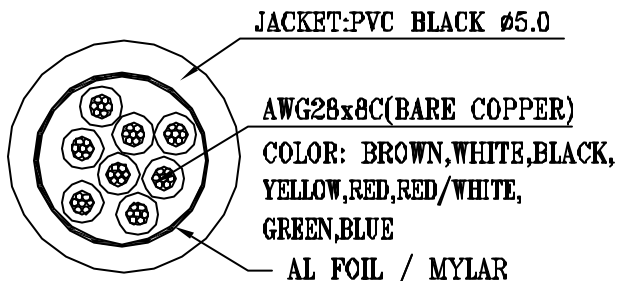

WIRE 1# CONFIG DETAIL

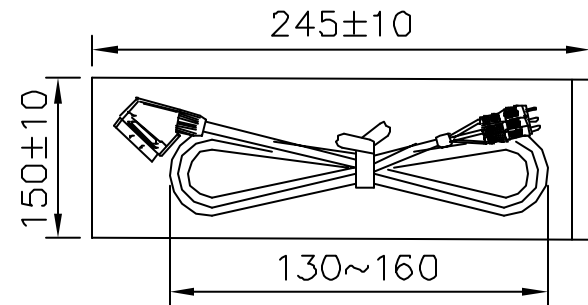

COLOR		CONNECTION	
		SCART 21P	
BLACK	2	—	P1: RED
BROWN	1	—	P2: WHITE
BLUE	4	—	
GREEN	2	—	P3: RED
RED	6	—	P4: WHITE
WHITE	20	—	P5: YELLOW
RED/WHITE	17	—	
YELLOW	19	—	P6: YELLOW

NO.	DESCRIPTION	DESCRIPTION	UNIT	Q'TY
1	CABLE WIRE(1)	28AWGx8C PVC MATTE BLACK OD:5.0mm	MM	1400
2	RCA CABLE(2)	(28AWGx1C+S)x1P PVC BLACK O.D:2.8mm 150mmx6pcs	MM	900
3	TERMINAL	0.35t Tin PLATED (BRASS)	PCS	8
4	METAL SHIELD	0.4t (SUS 304BA)	PCS	1
5	HOUSING	21P SCART CONN. BLACK (P.C)	PCS	1
6	COVER	UL (94V-0) BLACK (P.P)	PCS	1
7	RING	UL (94V-0) BLACK (P.P) (ø8.0)	PCS	1
8	H.S TUBE	ø1.0 125°C 300V BLACK L:25mm	PCS	1
	H.S TUBE	ø1.5 125°C 300V BLACK L:6mm	PCS	7
	H.S TUBE	ø3.0 125°C 300V BLACK L:15mm	PCS	4
	H.S TUBE	ø5.0 125°C 300V BLACK L:10mm	PCS	1
9	1st MOLDING	P.P	EA	1
	2nd MOLDING	60P PVC BLACK	EA	1
10	RCA PLUG	RCA PLUG Ni-Plated	PCS	6
11	1st MOLDING	P.P	EA	6
12	2nd MOLDING	60P PVC (B/W/B/G/R/Y)	EA	6
13	CABLE TIE	PVC CABLE TIE BLACK 100mm	EA	1

NOTES:
 1. RoHS COMPLIANT.
 2. Specify Length as Suffix on Part Number in mm.
 For Example:
 SCART-10345-1500 = 1500mm Long SCART Cable.

TOLERANCE		 1015 GRANT STREET S.E. ATLANTA, GA 30315	TITLE: SCART PLUG TO RCA PLUG x6 CABLE ASSY				
LINEAR	ANGLES		PART NO. SCART-10345-X				
X.±	X'.±		DWG NO. SC-10345				
.X±0.25	.X'±	APPD:	MAT'L:	UNITS			
.XX±0.15	.XX'±	CHKD:	FINISH:	MM	SCALE	SHEET	REV
.XXX±0.05	.XXX'±	DRWN: AXL	Q'TY:	MM	NONE	1 OF 1	A

A	ISSUED	AXL	1/3/07'
REV	ECN NO.	NAME	DATE